

Inspection specification	
Nominal pressure	PN
Gas seal test	0.6MPa
High pressure water seal	1.1xPN
Shell seal	1.5xPN
Applicable medium	Water,oil,etc
Applicable temperature	<input type="checkbox"/> EPDM-20-120℃
	<input type="checkbox"/> NBR: 0-80℃
	<input type="checkbox"/> PTFE- -20-120℃

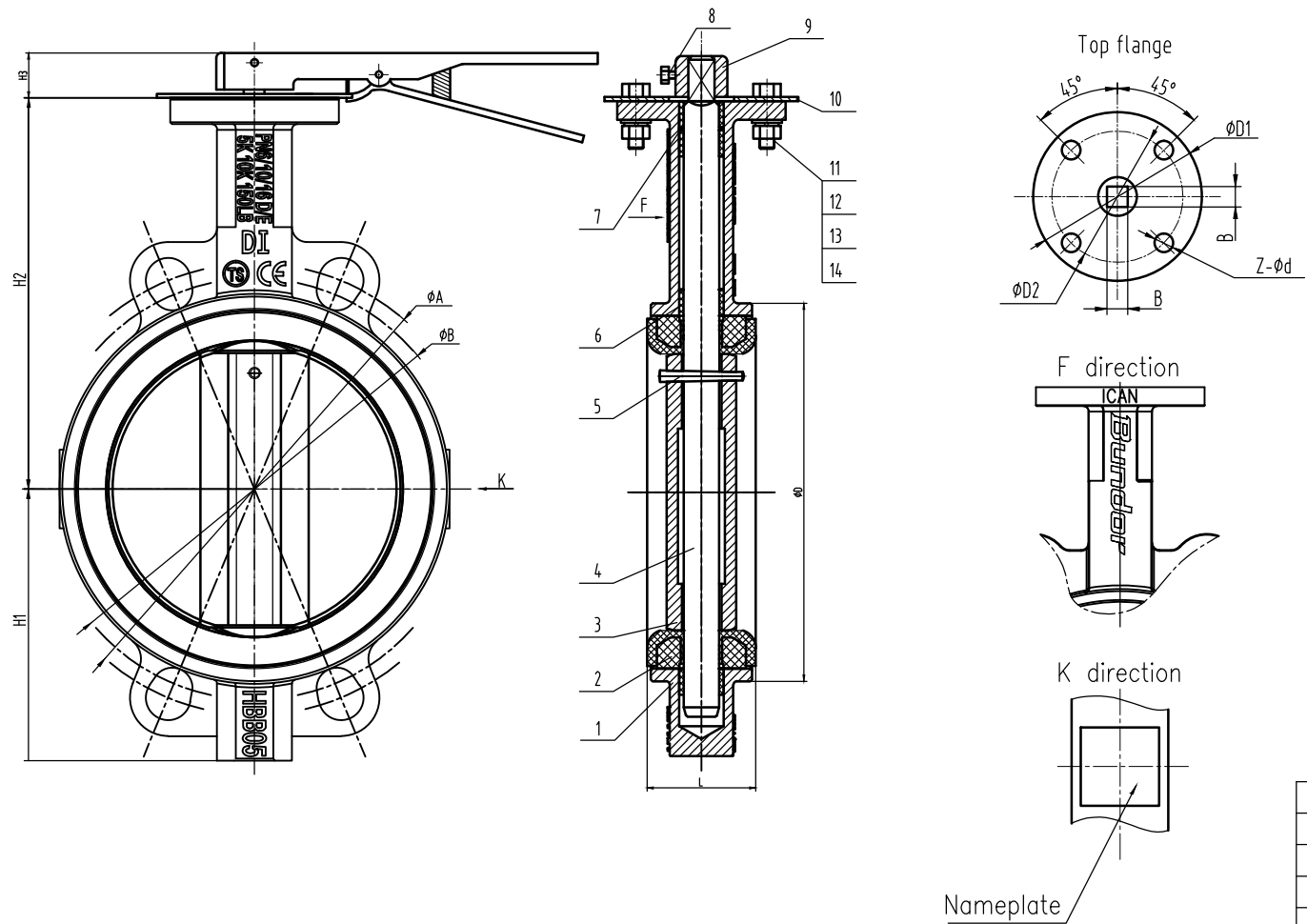

Technical requirements

- 1.Design and manufacture of valves should be consistent with GB / T 12238;
- 2.Valve structure length should comply with GB / T 12221;
- 3.Valve pressure temperature rating should be in accordance with GB/T 17241.7;
- 4.Valve inspection and test standards should comply with GB/T 13927;
- 5.The valve body side flange should conform to GB/T 9113.1/ ASME B16.5/ JIS 10K/ EN 1092-1
- 6.The valve shape shall be subject to the real object , and the drawing is only for reference.

14	GB/T 97.1	Flat pad	2	SS304
13	GB/T 6170	Nut	2	SS304
12	GB/T 93	Spring washer	2	SS304
11	GB/T 5781	Hex Bolts	2	SS304
10		Indicator disk	1	Chromed steel
9		Handle	1	DI
8	GB/T 5781	Hex Bolts	1	SS304
7		O-ring	1	EPDM/NBR
6		Bearing	3	Composite polymer
5		Pin	1	SS416/SS304
4		Stern	1	SS416
3		Disc	1	DI/CF8
2		Seat	1	EPDM/NBR
1		Body	1	DI

DN	in	H1	H2	H3	ϕD	ϕA	ϕB	L	PN10/16		ASME 150LB		JIS 10K		ISO 5211				
									ϕk	n- ϕd	ϕk	n- ϕd	ϕk	n- ϕd	$\phi D1$	$\phi D2$	Z-d	B	F
50	2"	80	129	24	87.1	125	105	43	125	4-18	120.6	4-19	120	4-19	65	50	4-8	9	F05
65	2.5"	82	136	24	100.4	145	127	46	145	4-18	139.7	4-19	140	4-19	65	50	4-8	9	F05
80	3"	95	153	24	116	160	145	46	160	8-18	152.4	4-19	150	8-19	65	50	4-8	9	F05
100	4"	110	167	24	147.6	190.5	165	52	180	8-18	190.5	8-19	175	8-19	90	70	4-10	11	F07
125	5"	122	193	27	172	216	200	56	210	8-18	215.9	8-22.4	210	8-23	90	70	4-10	14	F07
150	6"	141	209	27	202	241.3	225	56	240	8-22	241.3	8-22.4	240	8-23	90	70	4-10	14	F07
200	8"	170	251	30	253.7	298.4	280	60	295	8-22/12-22	298.5	8-22.4	290	12-23	125	102	4-12	17	F10
250	10"	213	283	30	308.8	362	355	68	350/355	12-22/12-26	361.9	12-25.4	355	12-25	125	102	4-12	22	F10
300	12"	240	315	30	362	431.8	390	78	400/410	12-22/12-26	431.8	12-25.4	400	16-25	125	102	4-12	22	F10

No.	Drawing No.	Name	Qty	Material
Assembly drawing				
				Butterfly valve
				50-600D71X